

# PM2 SHCVO C

## PRISM Shower Range Prism Recessed Thermostatic Dual Control Shower Valve Chrome



### Specification

Product Type:	Shower Mixer
Main Construction Material:	Brass
Connection Inlet:	15mm Compression
Connection Outlet:	15mm Compression
Number of Controls:	2
Flow Control Valve Type:	Thermostatic Cartridge & 3/4" Ceramic Disc Valve
Plumbing System:	Suitable for all plumbing system
Minimum Dynamic Pressure: (Bar)	0.2 Bar
Maximum Dynamic Pressure: (Bar)	5.0 Bar
Maximum Static Pressure:	10
Maximum Hot Water Temperature: (°C)	80
Pre-set Outlet Temperature:	42°C
Isolation Included:	No
Check Valve Supplied:	Yes

### Features:

- Slim design recessed shower valve will fit into a cavity space as small as 35mm for hassle-free installation.
- Dual control - Flow and temperature are operated separately giving accurate control of both.
- Thermostatic cartridge with preset temperature safety stop at 42°C for family-safe showering. A higher temperature can be selected, if required, by selecting the override function.
- Automatic shut-off in the event of hot or cold water supply failure for family safe showering.

### Product Certifications:



WRAS Cert. Number: 1910908  
WRAS Expiry Date: 31/10/2024



For more products, visit our website:  
<http://www.bristan.com>



### Dimensions (measurements in mm)

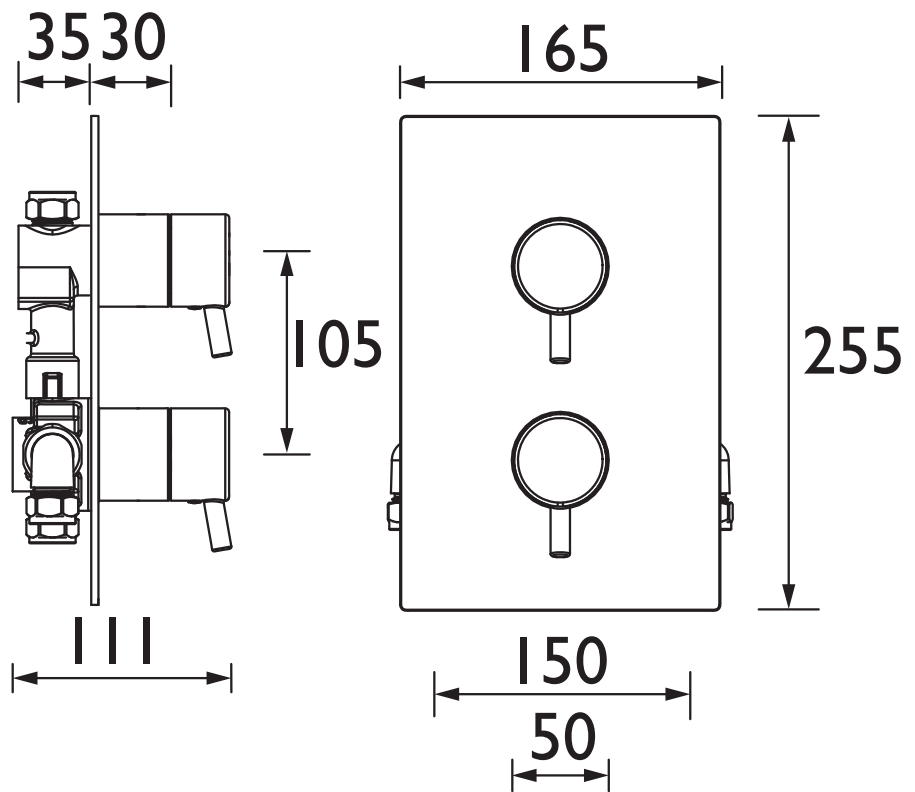

### Flow Rates (l/min)

System Pressure (bar)	0.2	0.5	1	2	3	5
Through Handset (mixed)	7.5	14.1	21	30.5	37.4	48.2

## TECHNICAL DATA SHEET



# BRISTAN

D6